



2 REAR ELEVATION



4 LEFT ELEVATION

AAC

PZ23-12000017

03/05/2025

COLOR SCHEME KEY

- | | |
|---|---|
| 1 | MAIN
SW 7757
HIGH REFLECTIVE WHITE |
| 2 | TRIMS
SW 7646
FIRST STAR |
| 3 | DETAIL COLOR
SW 7648
BIG CHILL |
| 4 | AWNING/BRACKETS
SW 7104
COTTON WHITE |
| 5 | RAILING/WINDOWS/
DOOR FRAMES
SW 7048
URBANE BRONZE |
| 6 | SHUTTERS/GARAGE DOORS
SW 9177
SALTY DOG |
| 7 | ROOFS
BARREL TILES
HUES OF CHARCOAL |
| 8 | STONE VENEER
FRENCH LIMESTONE CREAM |

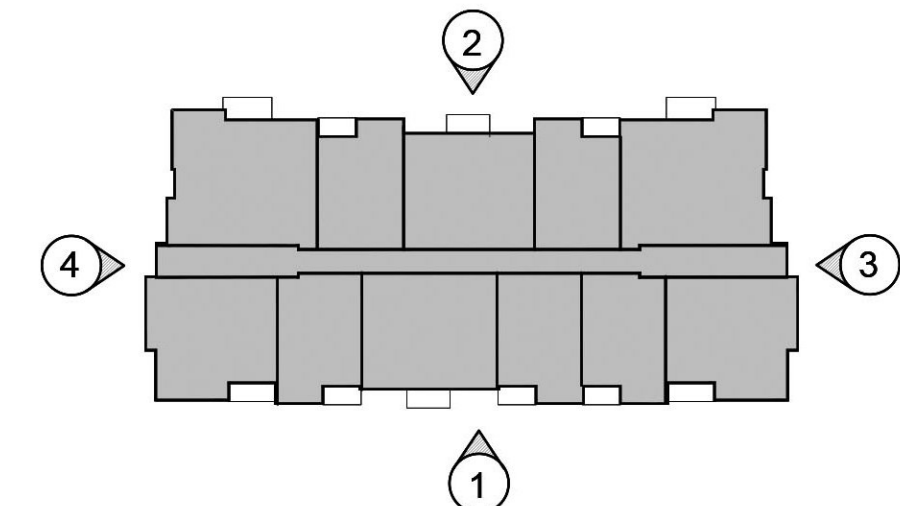

KEYPLAN

N.T.S.
BLDG IB ELEVATIONS

SCALE: 1/8"=1'-0"

PRE-APP MEETING 04/04/2023	BY
DRC SUBMITTAL 06/13/2023	
DRC RE-SUBMITTAL 08/16/2023	
DRC RE-SUBMITTAL 01/01/2024	
DRC RE-SUBMITTAL 10/16/2024	
DRC RE-SUBMITTAL 12/10/2024	
DRC RE-SUBMITTAL 01/29/2025	

OAKS @ PALM AIRE
FOR:
MORGUARD
LOCATED AT:
POMPANO BEACH, FLORIDA

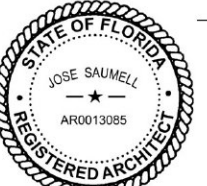

JOSE I. SAUMELL
AR0013085

MSA ARCHITECTS, INC.
AAC0000895
8950 SW 74th COURT
SUITE 1513
MIAMI, FLORIDA 33156
(305) 273-9911

MSA ARCHITECTS
ARCHITECTURE & PLANNING
ARCHITECT'S BUILDING CODE STATEMENT: TO THE BEST OF THE ARCHITECT'S KNOWLEDGE, THE PLANS AND SPECIFICATIONS COMPLY WITH THE FLORIDA BUILDING CODE SEVENTH EDITION (2020) AND THE APPLICABLE FIRE SAFETY STANDARDS AS DETERMINED BY THE LOCAL AUTHORITY AND CHAPTER 633 FLORIDA STATUTES.
COPYRIGHT © 2025 MSA ARCHITECTS, INC. ALL RIGHTS RESERVED. THIS BUILDING AND/OR OVERALL PROJECT ARE THE LEGAL PROPERTY OF AND ALL RIGHTS ARE RESERVED BY THE ARCHITECT.
THEIR USE FOR REPRODUCTION, CONSTRUCTION, OR DISTRIBUTION IS PROHIBITED UNLESS AUTHORIZED IN WRITING BY THE ARCHITECT.

DRAWN: JAV
CONTRACT DATE: 10/12/22
SCALE: AS SHOWN
JOB NO.: 2181.PRJ
SHEET TITLE:
BLDG ELEVATIONS

SHEET NUMBER:
A-3.1.2B